

All My Heart



MATERIALS

7825A Versa Clay
CC101-16 Cover Coat Artic White
CC206-16 Cover Coat Neon Red
PB26398 Pure Brilliance Dipping Glaze

SUPPLIES

Assorted Paintbrushes
Cardboard or Parchment Paper
Paper Towels
Water
Wooden Skewer

INSTRUCTIONS

1. Cut and roll out a slab of clay approximately $\frac{1}{2}$ " thick onto a sheet of cardboard or parchment paper.
2. Use an angled modeling tool - such as a wooden skewer - to cut out the wreath shape. Once cut, remove and place excess clay aside. Use your finger to smooth out edges with water.
3. Roll out excess clay flat - approximately $\frac{1}{4}$ " - $\frac{1}{2}$ " thick. Use excess clay to cut out multiple heart shapes.
4. To attach the hearts to the wreath base, score cross-hatch grooves onto each joining surface. Once scored, apply a layer of watered down clay to each scored surface and attach the pieces together. As each heart shape is attached, use your finger to blend the shapes together with water.
5. Attach an assortment of round shapes to the wreath. Layer each shape as desired.
6. Once clay is dry, use an assortment of Cover Coat paints to paint the project.
7. To create this project, paint each heart and each round accent shape with 3 coats of Artic White. On any layered round accent shape, paint the second layer shape with 3 coats of Neon Red. In the center of each round accent, paint a small heart using Artic White or Neon Red. Add Neon Red dots to scattered shapes. Paint cross hatch brushstrokes across each heart surface using Artic White and Neon Red. Paint the background wreath base with 3 coats of Neon Red.. Accent project as desired.
8. Allow project to dry completely for 5-7 days, or until clay is no longer cool to the touch.
9. Fire the completed project to cone 04.
10. Once fired, dip project in Pure Brilliance and fire to cone 06.

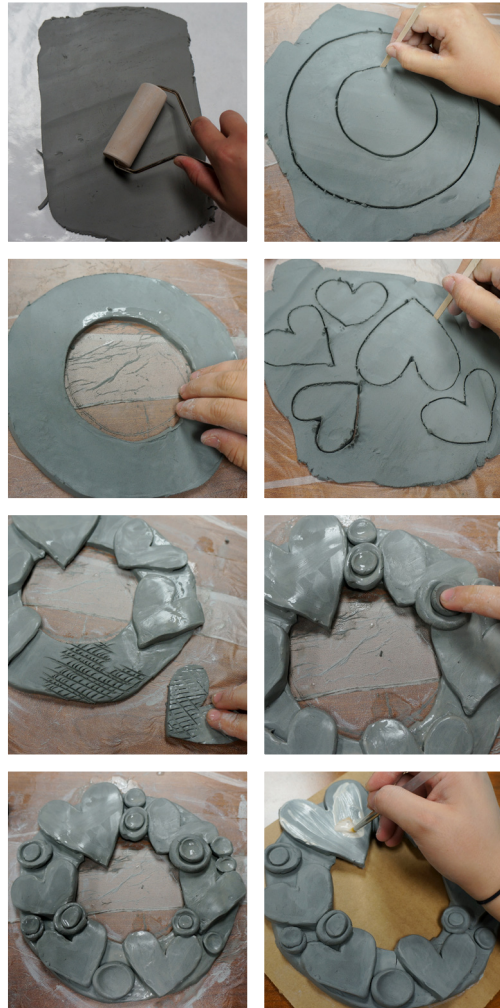

Materials Guide

7825A – Approx. $\frac{1}{2}$ lb. per project yields 100 projects
CC101-16 – 1 sand dollar-sized drop yields 100 projects
CC206-16 – 1 sand dollar-sized drop yields 100 projects
PB26398 – 1/6 cup yields approx. 100 projects

Price Per Camper : ~\$0.78